

## FDCH222

### Installation housing

Sinteso™  
Cerberus™ PRO



- 
- Housing with U-rail TS35 and end bracket
  - A maximum of three line adapters (Ex) FDCL221-Ex can be installed on the U-rail TS35
  - It is possible to install additional devices (e. g., line separator FDCL221)

## Properties

---

- **Eco-friendly**
  - Environmentally friendly processing
  - Reusable materials

## Technical data

---

Protection category according to EN 60529 IP66

Dimensions (W x H x D) 300 x 134 x 200 mm

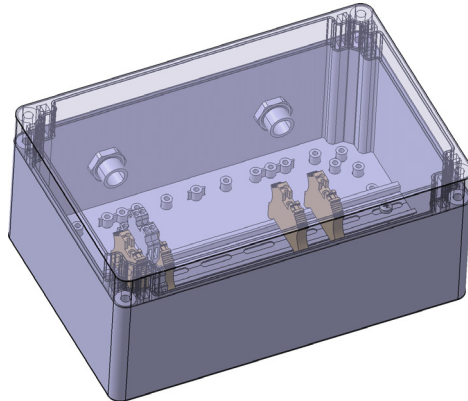

## Details for ordering

---

Type	Art. no.	Designation	Weight
FDCH222	S54329-F10-A1	Installation housing	0.500 kg

You will find additional information in the following documents:

- Equipment overview, doc no. 008164 (Sinteso), A6V10225323 (Cerberus PRO)
- Line adapter (Ex) FDCL221-Extechnical manual, doc no. A6V10333771
- FDCH222 installation instructions, doc no. A6V10397617